

House Type B

4 bedroom house
1,468 sqft / 136.4 sqm

GROUND FLOOR

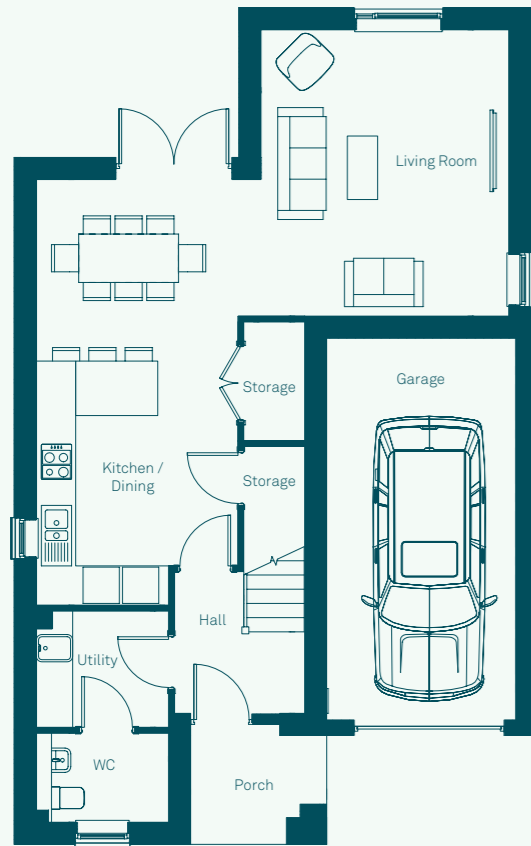

FIRST FLOOR

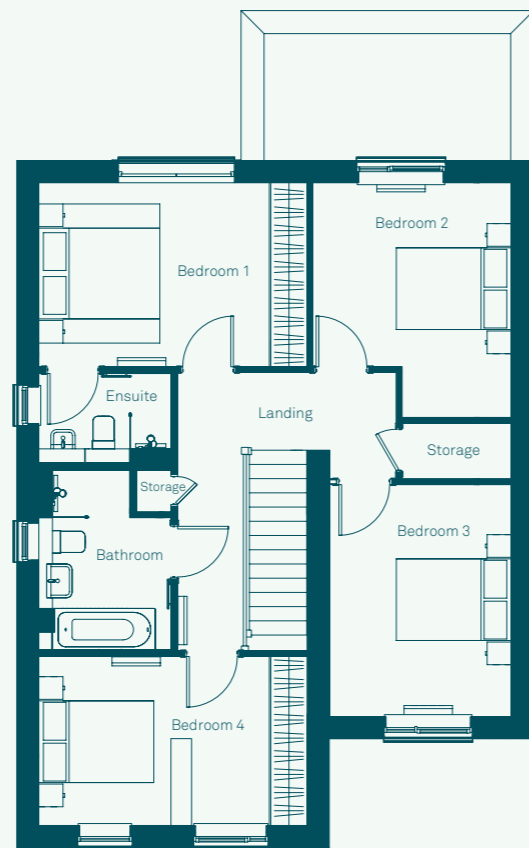

BOXWOOD PARK



House Type B

GROUND

Kitchen/Dining	6.0m x 3.7m 19'8" x 12'2"
Living Room	4.7m x 4.1m 15'5" x 13'5"
Utility	2.2m x 1.9m 7'3" x 6'3"
WC	2.2m x 1.5m 7'3" x 4'11"
Garage	6.3m x 3.1m 20'8" x 10'2"

FIRST

Bedroom 1	4.4m x 3.0m 14'5" x 9'10"
Ensuite	2.2m x 1.5m 7'3" x 4'11"
Bedroom 2	3.2m x 3.0m 10'6" x 9'10"
Bedroom 3	3.8m x 3.0m 12'6" x 9'10"
Bedroom 4	4.4m x 2.8m 14'5" x 9'2"
Bathroom	3.0m x 2.2m 9'10" x 7'3"

Computer generated image is indicative only.